

JM21 Complete User Manual

(Please update JM21 to latest firmware version first.)

All the pictures below are for illustrations only. Specifics are subject to the actual product.

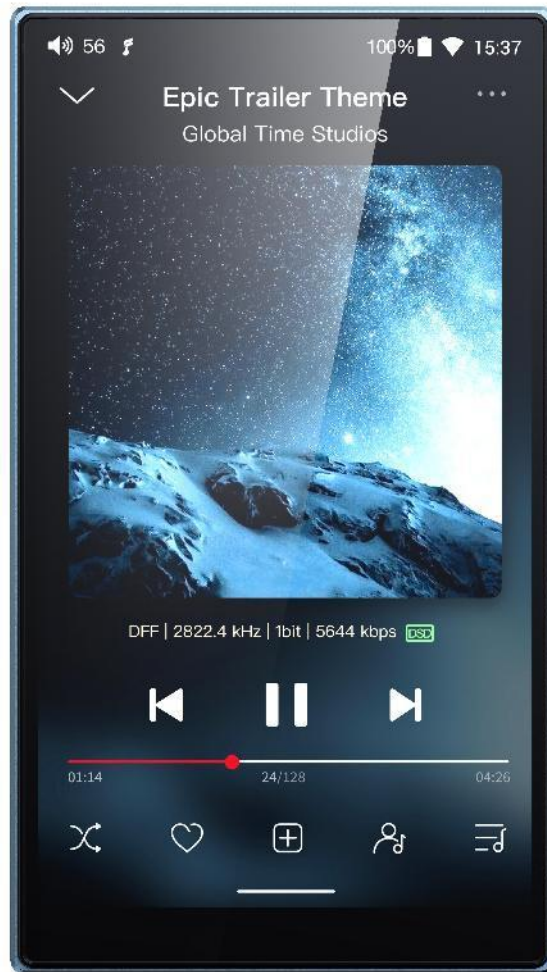

Foreword

Thank you so much for purchasing FiiO's portable high resolution lossless music player JM21. We have prepared this complete user manual for you. We hope this manual can help you get the hang of the JM21 and unleash its full potential.

Buttons and ports	5
1. Pictorial guide to buttons and ports	5
2. Instructions for buttons and ports	5
Status bar and display page	7
Instructions for entry-level functions	8
1. Five working modes	8
2. How to connect the JM21 to a computer	10
3. How to upgrade firmware?	11
4. How to install third-party apps?	12
5. How to change the language?	12
6. How to enable the USB DAC function?	13
7. How to use the JM21 as a Bluetooth transmitter?	14
8. What power supply adapter is suggested to charge the JM21?	15
Introduction to Settings menu	16
WiFi	16
Bluetooth	17
Bluetooth transmitting	17
Bluetooth receiving	19
Audio	20
Gain	21
Lowpass filter mode	21
Bluetooth Audio Encoder	22
Balance	22
All To DSD	22
Adjustable volume at LO	23
Display	23
Global	25
Double tap to wakeup	26
System	27
Languages & input	27
Reset options	28
FiiO Music APP	29
Instructions for commonly-used functions	36
1. Screenshot	36
2. USB Audio digital output	36
3. FiiO Link Bluetooth control	36
4. FiiO Link Wifi control	37
5. How to use the DLNA function?	37

6.How to use the coaxial function of JM21?	38
7. What can be done if I forget my password? How to enter recovery mode?	38
Firmware upgrade, factory data reset and technical support	39
1.How to upgrade firmware?	39
2.Force to reboot	40
3.Factory data reset	41
4.Technical support	41

Buttons and ports

1. Pictorial guide to buttons and ports

(Pictures are for reference only)

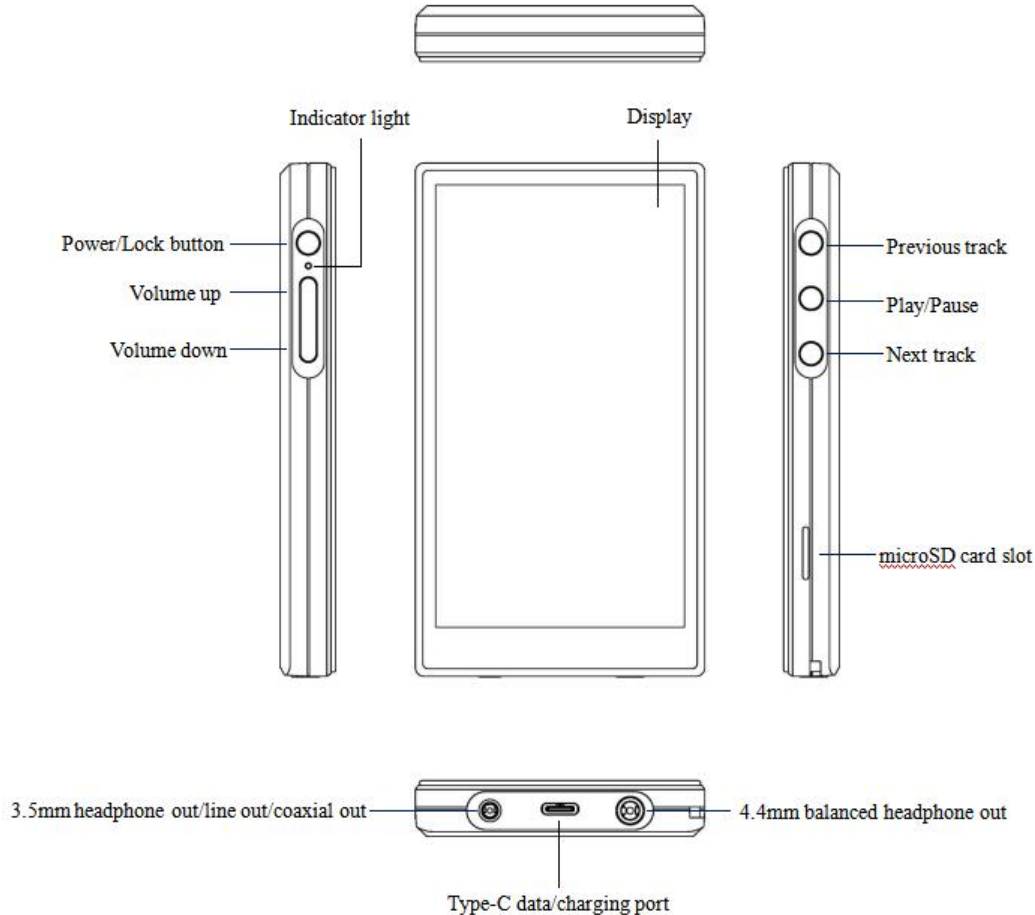

2. Instructions for buttons and ports

1) Power/Lockscreen: Hold the Power/Lock button to turn on the JM21. On its first startup, tap the preferred language onscreen to enter the main UI. Hold the Power/Lock button while the JM21 is on and a shutdown dialogue will pop up. You can select to turn off or reboot the player.

2) Previous track: short press to play the previous track; long press to rewind.

3) Play/Pause: short press it when music is playing to pause the music; short press it when music is paused to resume the playback.

4) Next track: short press to play the next track; long press to fastforward.

5) microSD card slot: supports one TF card (micro SD card), theoretically up to 2TB expansion.

6) Volume up/down: press the volume up button to increase the volume, press the volume down button to decrease the volume.

7)USB Type C transfer/charging port: used for charging, data transmission and USB Audio.

8) 4.4mm balanced output: supports 4.4mm balanced headphone output.

9) 3.5mm headphone/line-out/SPDIF output: shared outputs of line-out, spdif out and PO

The priority of the JM21 output port

1. When the 3.5mm and 4.4mm earphones are inserted at the same time at the same time, the output will be given priority in the order of insertion

2. According to the Android system's own processing method, Bluetooth transmission and analog output (including SPDIF) will follow the principle of post-access priority.

Status bar and display page

The status bar on the top screen shows the working states of the JM21.

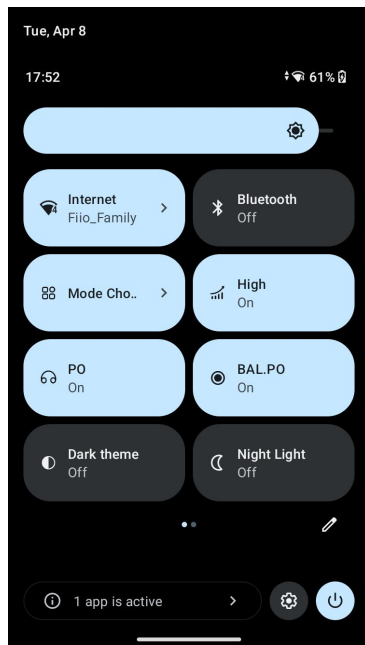

Instructions for entry-level functions

1. Five working modes

The JM21 supports five working modes, including Android mode, Pure Music mode, AirPlay, USB DAC mode and Bluetooth Receiving mode. It is defaulted to be Android mode when the device is powered on for the first time, which can be switched to other modes on the drop-down or settings menu.

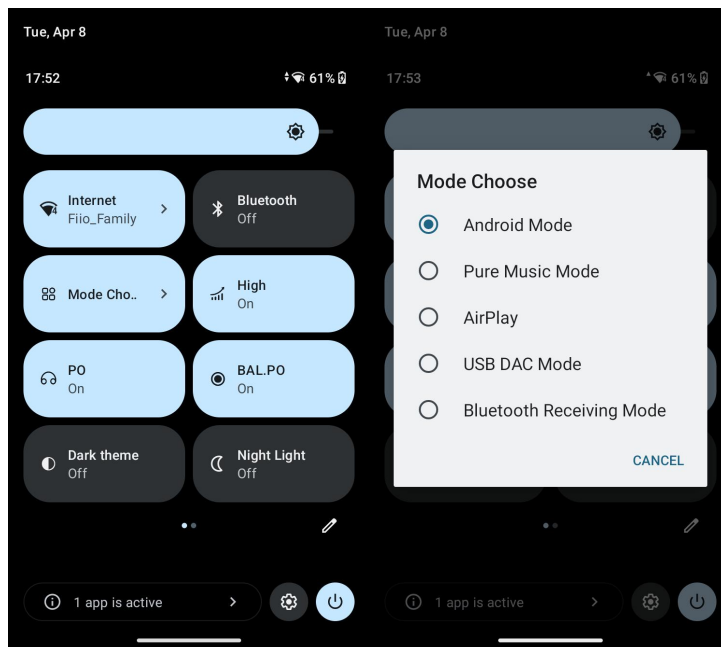

Android mode

Third party applications will be available at will. It can be switched to other modes on the drop-down or settings menu.

Pure Music mode

Third party applications will be automatically disabled while FiiO Music app will be auto-enabled. It can be switched to other modes on the drop-down or settings menu.

AirPlay

The JM21 can be connected to Apple devices, receiving audio signals transmitted from them.

USB DAC mode

In USB DAC mode, the JM21 can be connected to other devices like a computer, working as a USB DAC/Amp. It can be switched to other modes on the drop-down or settings menu.

Notes: when the JM21 is going to work in the USB DAC mode for the first time, FiiO's exclusive USB DAC driver is required. Please download it on our website and follow relevant instructions to install it.

Bluetooth Receiving mode

The JM21 can be connected to Bluetooth transmitting devices like a mobile phone, working as a Bluetooth DAC/Amp. It can be switched to other modes on the drop-down or settings menu.

2. How to connect the JM21 to a computer

For Windows systems, the JM21 runs driver-free. Connect the JM21 to the computer through the included USB cable, the required driver will be automatically installed. After it is finished, the FiiO JM21 disk can be directly seen on the computer.

For Mac systems, a driver is needed.

1) After connecting the JM21 to the Mac computer, click the "NO NAME" folder emerging on the desktop->double click Mac->Mac/MAC OS MTP Client->Android File Transfer.dmg. Drag the "Android File Transfer.dmg" to the desktop of the computer.

2) Drag the "Android File Transfer" file to the "Applications" folder and wait for the completion of the copy.

3) Enter "Applications", and double click the "Android File Transfer".

Then

you can manage the files stored in the internal storage of the JM21 or the Micro SD card.

Notes: The JM21 folder will directly pop up the next time it is being connected to the same computer.

3. How to upgrade firmware?

The JM21 supports online upgrade and local upgrade.

1) Online upgrade

If a new firmware is available and can be detected (with the JM21 connected to an available internet), an upgrade notification will show up in the notification center. Tap on it to enter the update menu for the online upgrade. If there's no upgrade notification showing up, you can go to the "Technical Support->Firmware Upgrade" menu, and tap the "Check for updates" icon to check manually.

2) Local upgrade

Also, the JM21 can be upgraded locally by a firmware package.

Download the firmware package file from FiiO.com, and copy it to the internal storage of the JM21 or an SD card. Go to the "Technical Support->Firmware Upgrade->Local Upgrade" menu, and find the firmware package file to start the upgrade.

Notes:

1) Do not unzip the firmware package file.

2) Before the upgrade, ensure the power of the device is adequate (>30%) so to avoid upgrade failure.

3) If the device goes to factory mode which cannot detect the firmware, the reason may be that the firmware file is damaged. At this time, press the power button to reboot the device. Re-download the firmware file and restart the upgrade.

4. How to install third-party apps?

There are two ways that are similar to mobile phones' to install applications.

1) Method 1: After connecting the device to a valid WiFi, go to FiiO market, Google Play or other app markets to download and install the app directly.

2) Method 2 (Local installation): copy the APK file to the JM21. Go to the file management menu to find the file and install it.

5. How to change the language?

Go to Settings->System->Languages and input->Languages->Add a language to choose the intended language. Press the "=" icon on the right side and drag it to the first line to select the language successfully.

The language of the FiiO Music app defaults to follow the system's. You can also go to FiiO Music app-> Settings->Languages to choose the language independently.

6. How to enable the USB DAC function?

For Mac computers, the JM21 runs driver-free.

For Windows computers, please make the settings as the followed steps.

- 1) Install the FiiO DAC driver in the computer first.
- 2) Switch the working mode of the JM21 to USB DAC mode on the drop-down menu or go to Settings->Mode choose menu to enter the USB DAC mode.
- 3) Connect the JM21 to the computer by the USB port. Select the JM21 as the audio input both in the computer and the music app, so it can work.

Notes:

When in the USB DAC mode, the JM21 does not support Bluetooth transmitting.

7. How to use the JM21 as a Bluetooth transmitter?

It is similar to mobile phone's. Here are the instructions.

- 1) Go to the Settings->Bluetooth menu to turn on the Bluetooth function.
- 2) Make the Bluetooth receiving device, such as Bluetooth earphones, enter the pairing state. (Please refer to the user manual of the Bluetooth receiving device about how to enter the pairing state.)
- 3) Go to the Bluetooth device list of the JM21->Pair new device to complete the connection.

What can be done if the JM21 fails to connect to Bluetooth earphones?

If it fails to connect to Bluetooth earphones for the first time, please make sure the earphones are in the pairing state (the connection will fail if the earphones are in reconnecting state for the first-time connection). Go to the Bluetooth menu of the JM21 to start the connection.

What Bluetooth codecs does the JM21 support? And how to switch the Bluetooth codecs?

The JM21 supports LDAC, aptX-HD, aptX, AAC and SBC which can be switched on Settings->Audio->Wireless playback quality menu. Note

that it needs to be disconnected and reconnected to enable the new codec after changing it.

What can be done if the volume is too low when the JM21 is connected to AirPods?

1. Go to System Settings-Audio and find the Bluetooth volume adjustment mode.
2. Switch the volume adjustment mode to Sync Bluetooth volume.
3. Disconnect and reconnect the Bluetooth device.

8. What power supply adapter is suggested to charge the JM21?

The JM21 doesn't support fast charging. It is recommended to use a 5V2A charger for charging.

Battery capacity: 2400mAh

Battery life: 12 hours (3.5mm standard headphone out)

Introduction to Settings menu

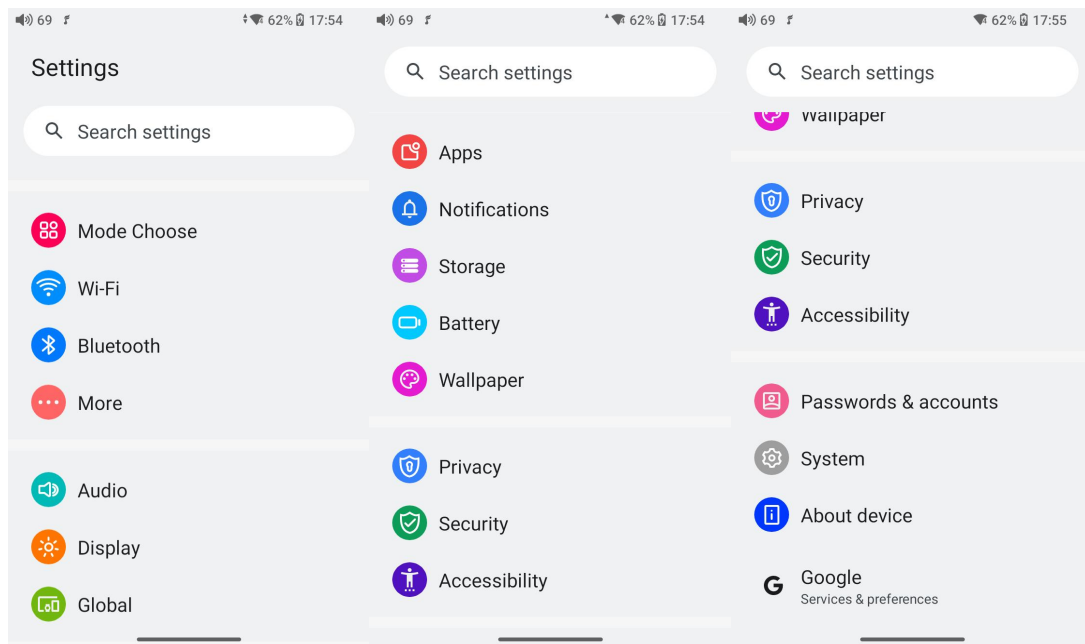

WiFi

The JM21 supports a WiFi connection of 2.4/5G dual-band for music resources access. Here are the steps to connect the JM21 to a new WiFi device.

- 1) In the settings menu of the JM21, tap "WiFi".
- 2) Turn it on. The JM21 will automatically search for and list available WiFi devices nearby.
- 3) Tap the intended WiFi device and connect them.

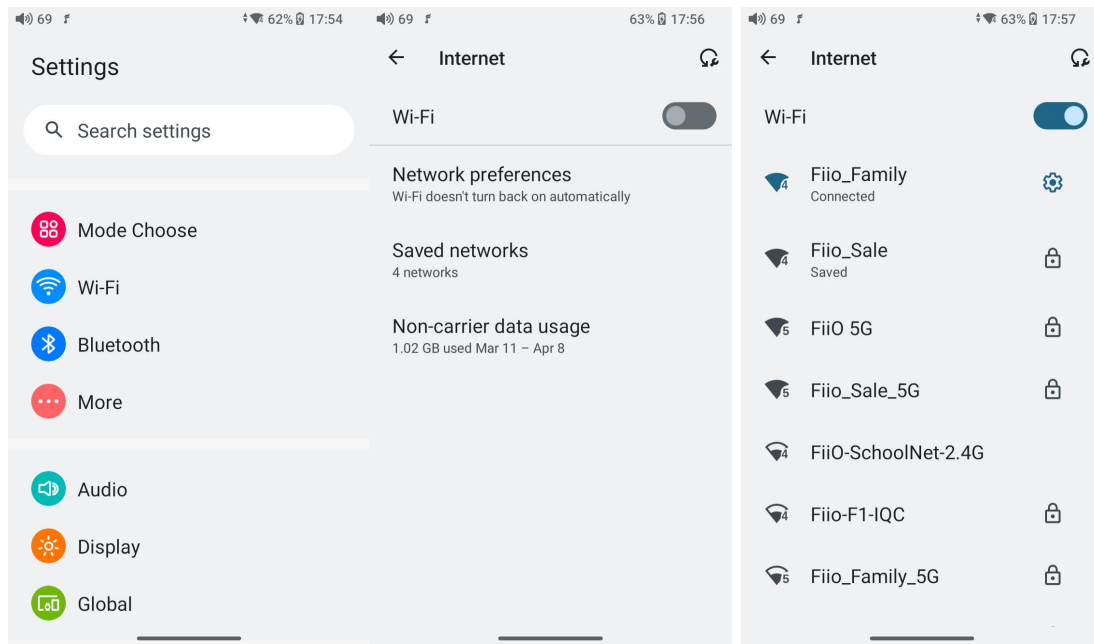

Bluetooth

The JM21 supports lots of Bluetooth codecs for both transmission and reception, allowing for rich wireless connections.

Bluetooth transmitting

When being a Bluetooth transmitter connecting to new Bluetooth devices (such as Bluetooth headphones, Bluetooth speakers), the JM21 needs to pair with the Bluetooth device first. Here are the steps.

1. Go to the Settings->Bluetooth menu to turn on the Bluetooth function.
2. Make the Bluetooth receiving device, such as Bluetooth earphones, enter the pairing state. (Please refer to the user manual of the Bluetooth receiving device about how to enter pairing state.)

3. Go to the Bluetooth device list of the JM21 -> Pair new device to complete the connection.

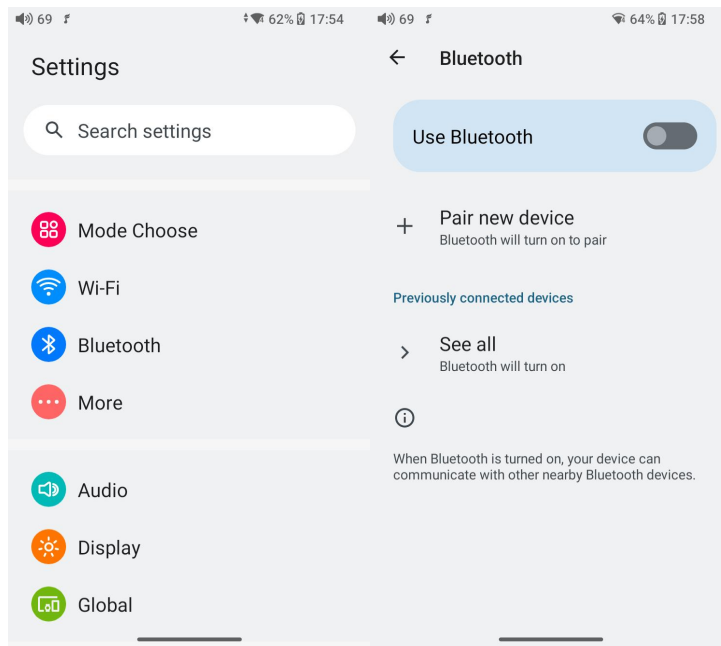

What can be done if the JM21 fails to connect to Bluetooth earphones?

If it fails to connect to Bluetooth earphones for the first time, please make sure the earphones are under pairing state (the connection will fail if the earphones are under reconnecting state for the first-time connection). Go to the Bluetooth menu of the JM21 to start the connection.

What Bluetooth codecs does the JM21 support? And how to switch the Bluetooth codecs?

The JM21 supports LHDC, LDAC, aptX-HD, aptX, AAC and SBC which can be switched on Settings->Audio->Wireless playback quality menu. Note that it needs to be disconnected and reconnected to enable the new codec after changing it.

What can be done if the volume is too low when the JM21 is connected to AirPods?

1. Go to System Settings-Audio and find the Bluetooth volume adjustment mode.

2. Switch the volume adjustment mode to Sync Bluetooth volume.
3. Disconnect and reconnect the Bluetooth device.

Note: When the Bluetooth is enabled, the JM21 will preferentially connect to the last-connected available Bluetooth devices.

Bluetooth receiving

When the JM21 is working as a Bluetooth receiver to connect to a new Bluetooth device, such as a mobile phone, turn on the Bluetooth, go to the Settings menu-> Mode choose, and select Bluetooth Receiving Mode. When it is enabled, the JM21 will automatically enter the BT Receiving UI.

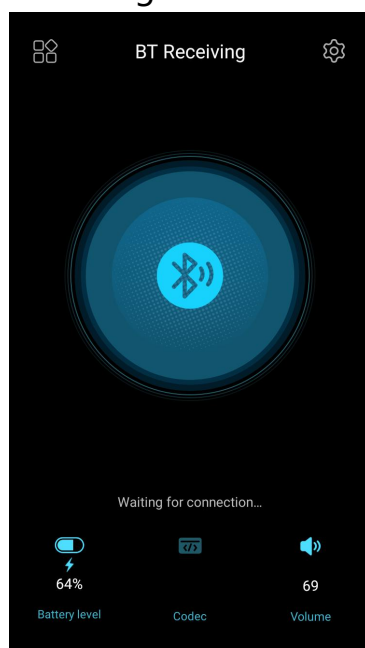

Audio

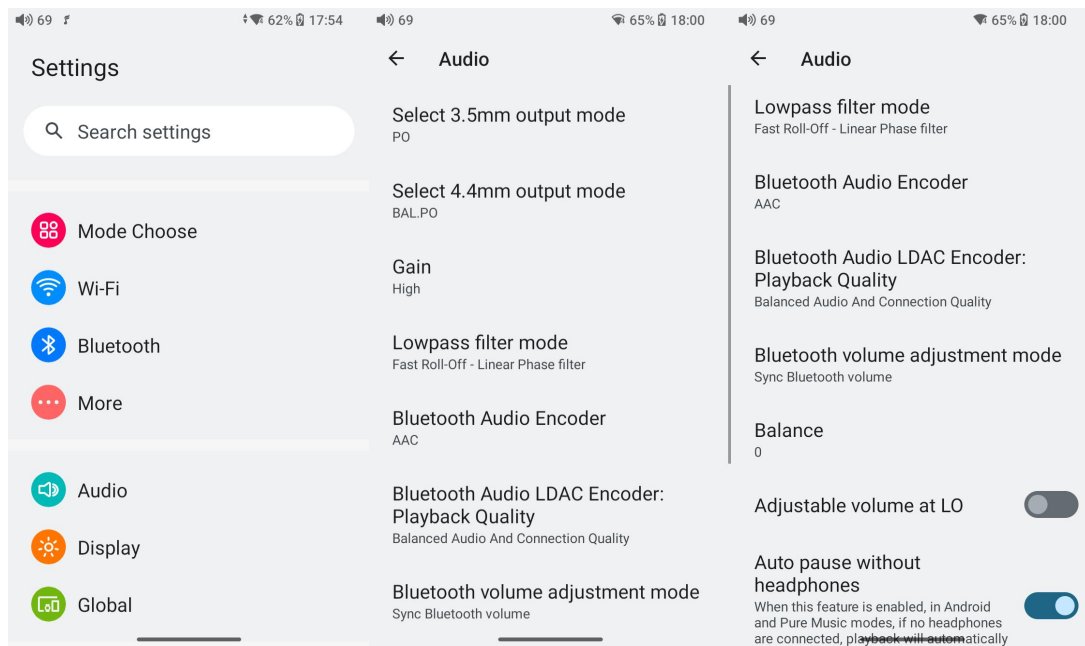

Output selection

3.5 Output selection

PO (Power output), generally used when connecting to earphones and speakers

LO (Line out), generally used when connecting to power amplifiers

SPDIF (Coaxial out), generally used when connecting to DACs

4.4 Output selection

BAL.PO and BAL.LO available

SPDIF out (it only needs to be set in this way when the coaxial output is used)

D2P mode: when playing PCM signals, it will output raw PCM signals;

when playing DSD signals, it will first convert DSD to PCM and output PCM signals.

DoP mode: PCM will be output as PCM signals while DSD will be output as raw DSD signals.

Notes:

Select DoP first. For some devices that are not supportive of DoP, please select D2P.

Gain

There are 3 levels, High, Medium and Low, corresponding to 3 levels of output voltages. You can select different Gains according to the earphones used.

Lowpass filter mode

There are 7 different filters (internal configuration of the ES9038Q2M) built in the JM21 for your preference.

Filters are the sound effects born with the chip, which only has slight adjustments for the sound. Here are some introductions to different filters. These are only for reference since actual listening also has something to do with the matched device.

- 1) fast roll-off,linear phase filter: Most Common filter with clean suppression and high rejection, best for music with high transients. Provides crisp clean highs
- 2) slow roll-off,linear phase filter: coherent and clear sounds, positioned near the middle. It is suitable for classical music.
- 3) fast roll-off, minimum phase filter: Minimal Pre- Ringing, preferred for Imaging and soundstage. No aliasing in frequency domain. Stronger bass than Linear Phase,clean highs

4) slow roll-off, minimum phase filter: Non-Symmetrical filter designed to minimize pre-ringing. Strong punchy bass with good transient attacks

5) apodizing fast roll-off, linear phase filter: Version of Linear phase fast roll-off filter optimized to improve pre-ringing.

6) hybrid fast roll-off, minimum phase filter: Combination of Linear-phase and Minimum-phase. Fast transient attack, strong punchy bass, crisp highs.

7) brickwall filter: One of the earliest designs, intended for highest suppression possible, with high delay and pre-ringing.

Bluetooth Audio Encoder

The Bluetooth transmission takes the highest codec by default. You can choose the highest codec supported for the Bluetooth connection by this option.

Balance

If there is any imbalance between the left and right channels when playing music, you can adjust the channel balance here. It has up to 10 levels available.

All To DSD

When the All To DSD function is turned on, the PCM signals will be converted to DSD for output with sound quality further improved.

【Principle】 All To DSD is mainly about switching digital signals from PCM to DSD format. So when making digital-to-analog conversion, it can use DSD format, enriching music styles with clearer and natural sound quality. In addition, since the lowest format of the DSD is DSD64, i.e. 4 times of the 44.1k/16bit (just looking at the data size), the All To DSD function is upsampling the 44.1k/16bit audio signals. Third-party apps also support All To DSD.

Notice: the All To DSD mode will heat up the device more seriously, and the battery life will be relatively shortened.

Adjustable volume at LO

When it is selected, the volume is adjustable at LO output. Otherwise, it is fixed at the maximum volume.

Auto pause without headphones

When this feature is enabled, in Android and Pure music modes, if no headphones are connected, playback will automatically pause after 2 minutes.

Display

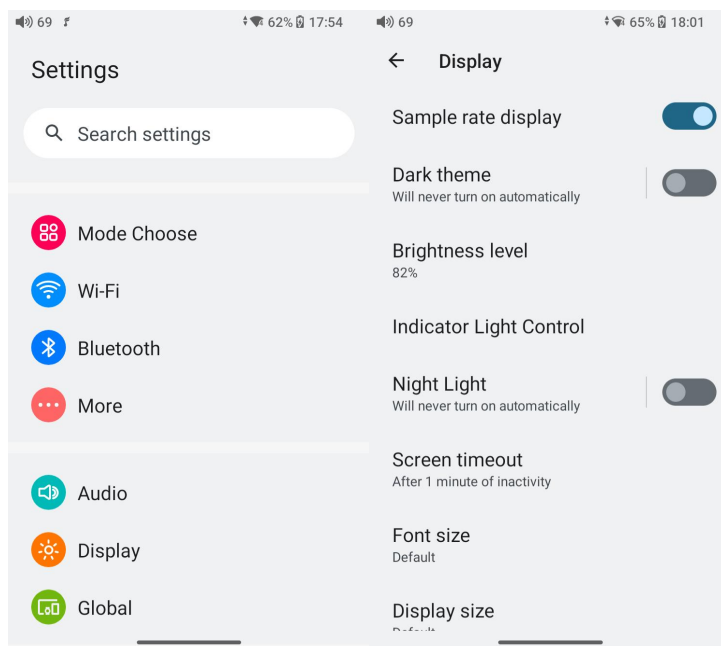

The display settings consist of Sample rate display, Dark theme, Brightness level, Indicator light control, Night light, Screen timeout, Font size, Display size, Screen saver and lock screen display. The following are detailed descriptions of some common item.

Sample rate display

With it turned on, the sample rate of the currently playing song will be displayed.

Dark theme

With it turned on, the theme will switch from the default white theme to a dark theme.

Brightness level

Adjusting the brightness of the JM21.

Indicator light control

Working: while working, two states can be set: constantly on and off

On/off with the display: After enabling it, the indicator will on on off synchronously with the screen

Indicator colour setting instruction:

Setting item	Indicator	Instruction
Brightness	Custom	Brightness level 0-100 Adjustable
Working state	Constantly on	Red indicator on while charging. Red indicator off while fully charged and indicator display other working states.
	OFF	

Night light

The color of the display screen will be adjusted in amber under Night light mode. You could enable the Night light mode at a custom time , or from sunset to sunrise.

Screen timeout

Consistent with the screen saver time. Adding this option to make it easier for users to adjust the time.

Font size

Customize the font size according to your preference.

Display size

Make the items on your screen smaller or larger according to your preference.

Screen saver

You can choose our customized screen saver or system screen saver for JM21.

Lock screen

Setting the content to be displayed when the screen is locked

Global

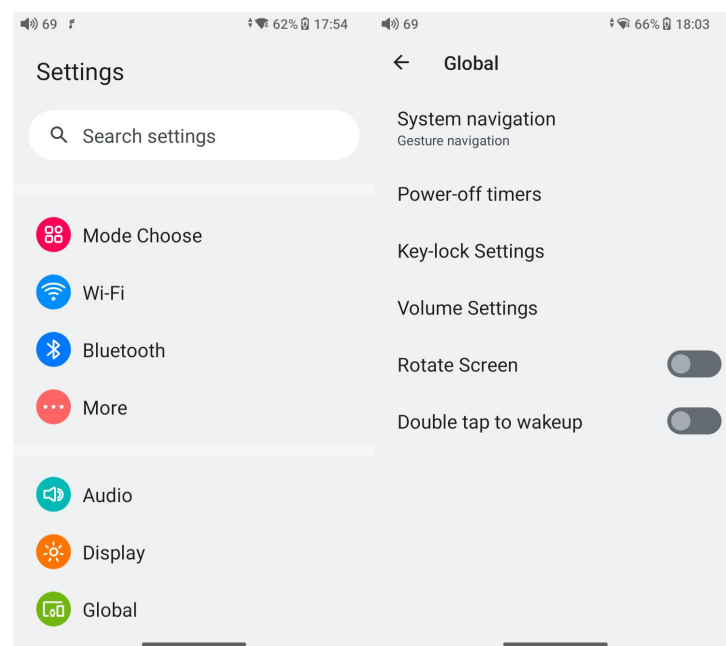

System navigation

Gesture, 2-button and 3-button navigation are available.

Power-off timers

There are two types of the timer, Sleep and Idle poweroff.

Sleep

when the set time is up, the JM21 will turn off automatically. The sleep time can be set as any integer values between 0 and 120.

Idle poweroff

the JM21 will automatically turn off when the timer reaches the set time for idle poweroff when there is no operation or playback. During this process, the timer will restart if there is any operation or playback. The idle poweroff time can be set as any integer values between 0 and 24h. (Note that this function will be disabled when it is set to OFF.)

Key-lock settings

Choose the buttons/knob you want to be available when screen off.

Volume setting

a. System Maximum volume setting: all other volumes will be lower than this volume after setting it.

b. Power-up default setting: set the volume of the system when the device is turned on.

Rotate screen

The display page will rotate 180° if it is enabled.

Double tap to wakeup

If the Double tap to wakeup function is enabled, the sleep device can be wake up by double-tapping the screen.

System

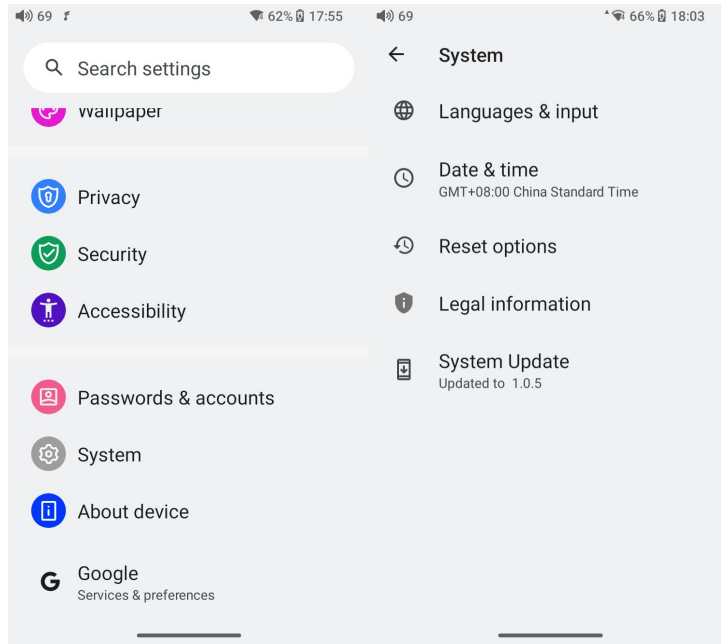

Languages & input

The first time the device starts up, you can choose an appropriate language from the prompt.

If you want to choose other languages, you can go to the Settings menu. Here are the instructions.

- 1) Go to the menu of Settings-> System-> Languages & input-> Languages;
- 2) In the Languages page, tap Add a language;
- 3) Select a language;
- 4) After selecting the language, hold the “=” icon on the right side of the target language and drag it to the top, so to successfully select the language.

Reset options

"Reset WiFi, mobile & Bluetooth" will reset all network settings, including WiFi and Bluetooth.

"Reset app preferences" will reset all preferences including the items shown in the following picture.

"Erase all data", i.e. factory reset, will erase all data from your device's internal storage, and all settings will be reset to default. **Please back up your important data before resetting.**

FiiO Music APP

The JM21 has built in the FiiO Music app, a professional audio playing application specially developing for Android-based system and flagship-grade music players.

Homepage

FiiO Music APP will enter the homepage once it starts up as shown below.

FiiO Music will enter the homepage once it starts up as shown below.

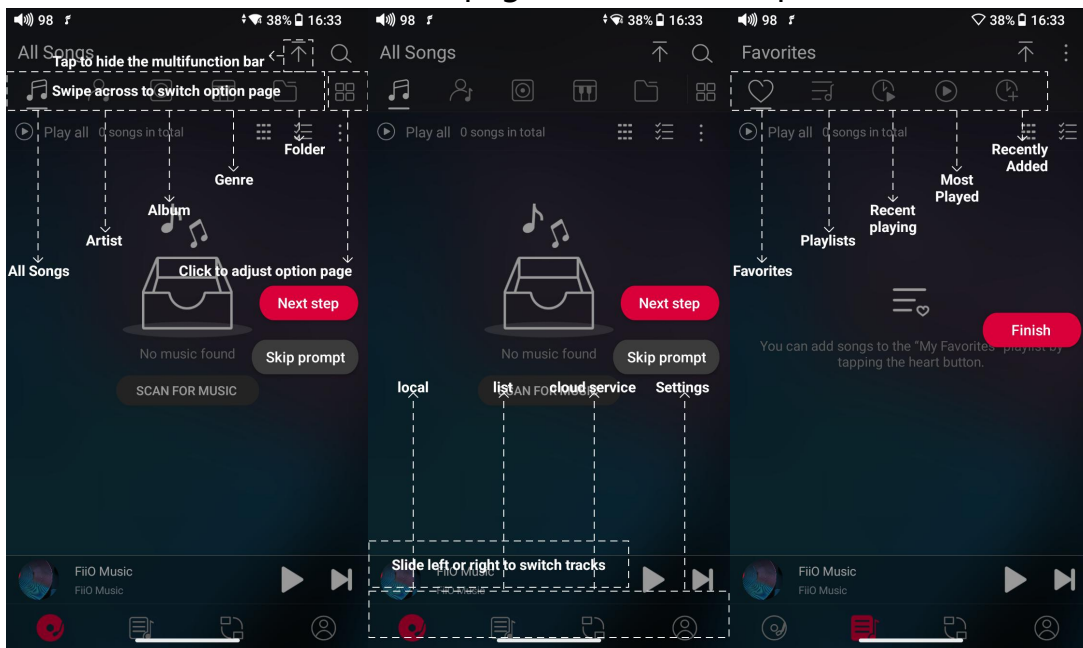

Quickly locate all songs

Slide the screen with your finger on the letter bar at the right side. A quick search icon will show up in the middle of the screen. Sliding to corresponding initials and relieving your finger, it will directly jump to the songs starting with the initial you have chosen.

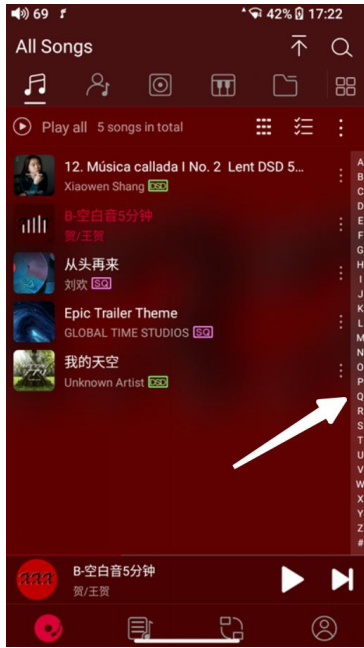

Hidden menu

Tap the  icon at the right corner of each track to wake up the hidden menu. Then tap the icon in the menu to perform corresponding operations.

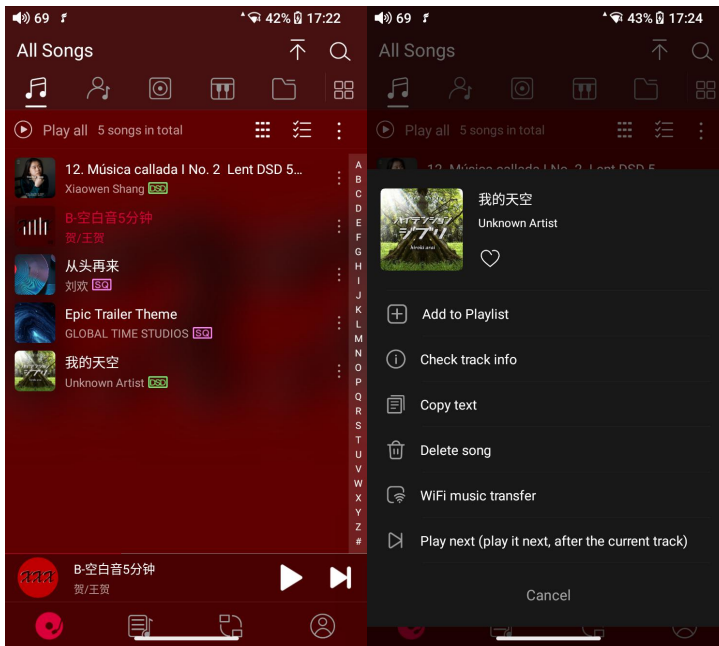

Sort songs

Tapping the hidden menu on the upper right corner of the screen, you can decide the way of songs sorted as Sort by date added, Sort by filename, Sort by the first letter and Sort by year.

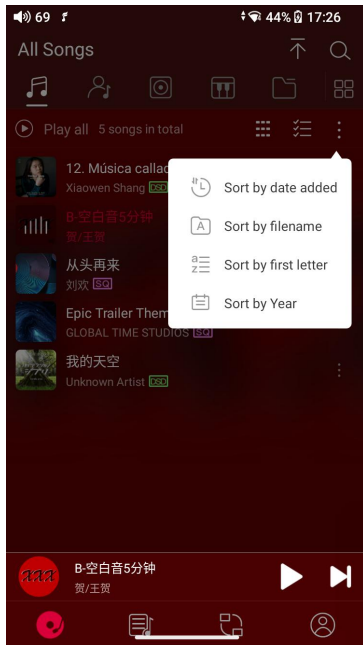

Bulk management

Play music, WiFi music transfer, Add to my favorites, Add to playlists, Delete selected, and Exit bulk management.

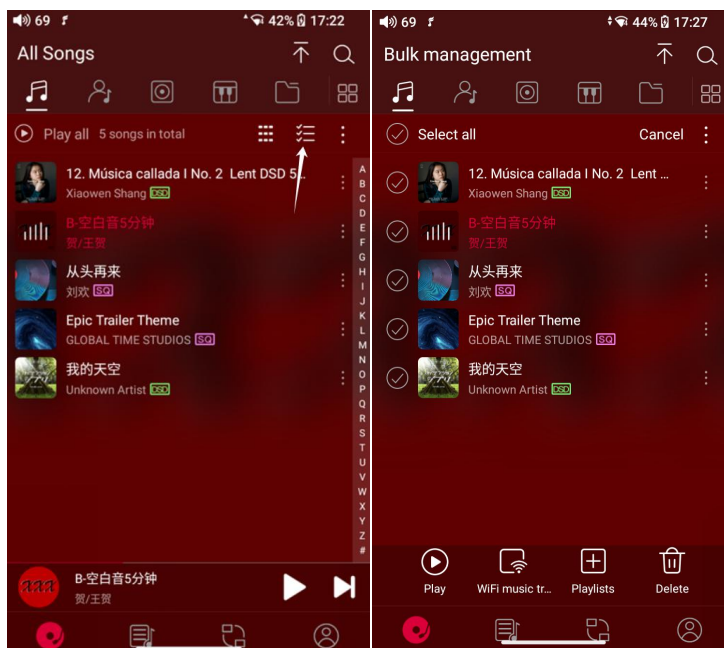

Playing page

Tap the album cover in the bottom left corner to enter now playing page.

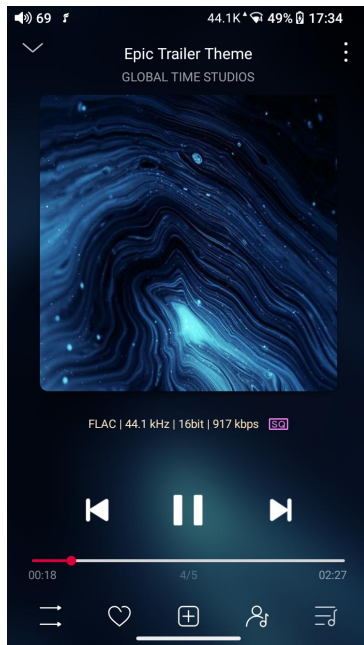

Switch page

By tapping the middle of the album cover, it will switch pages between album cover and lyrics circularly. Swipe left and right to switch songs.

Playing progress

Slide left and right on the progress bar below the album cover to quickly adjust the progress of the now playing song.

Notes: on the lyrics display page, you can adjust the song progress, lyrics timeline and font size.

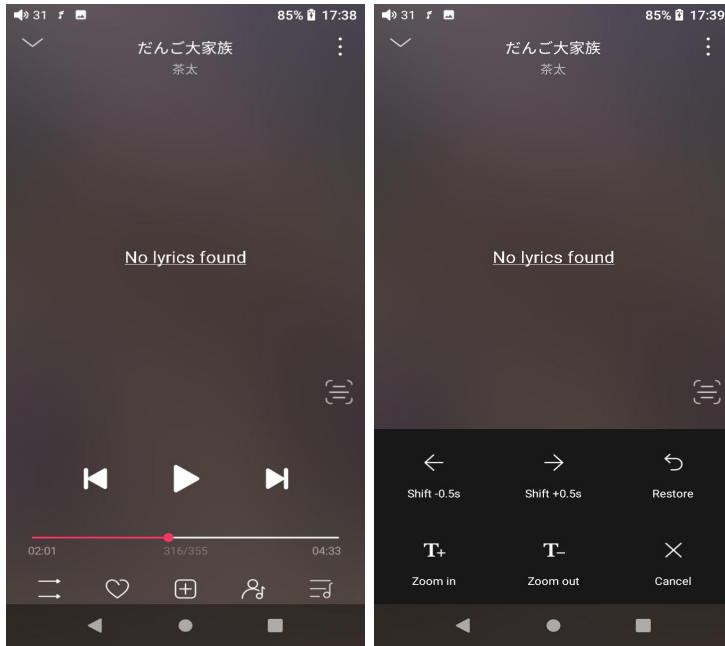

Equalizer

FiiO Music has a built-in equalizer, on which you can straightly choose the preset EQ for listening, or adjust it through the 10 frequency bands within 20Hz~20kHz from -12 to +12 dB, fully meeting personal music tastes.



Choose preset EQ: swipe left or right on the bottom of the screen to switch equalizer.

Customized EQ: drag the corresponding frequency band up and down to slightly adjust the EQ curve (on the bands page, switch left and right to change the option). Successively adjusting the EQ in need, it will immediately take effect.

Reset EQ: Tap the Reset button at the upper right corner to reset the present EQ.

Notes: if the system is reset to factory mode, all EQ settings will be reset to default.

UV meter

There is a newly added UV meter (audio meter) with a dB threshold and dynamic pointer displayed. Closing to the red threshold of 0dB means audio distortion.

How to enable it: tap the song cover on the now playing page to enter the UV meter displaying page.



Frequency spectrum playing page

There is a newly added frequency spectrum mode in the now playing page, which has 3 built-in spectrum effects available. Besides, users can self-define Full screen display or Original display for the spectrum mode. How to enable it: go to the Settings menu in FiiO Music app->Theme->Now playing page. Choose Spectrum display.

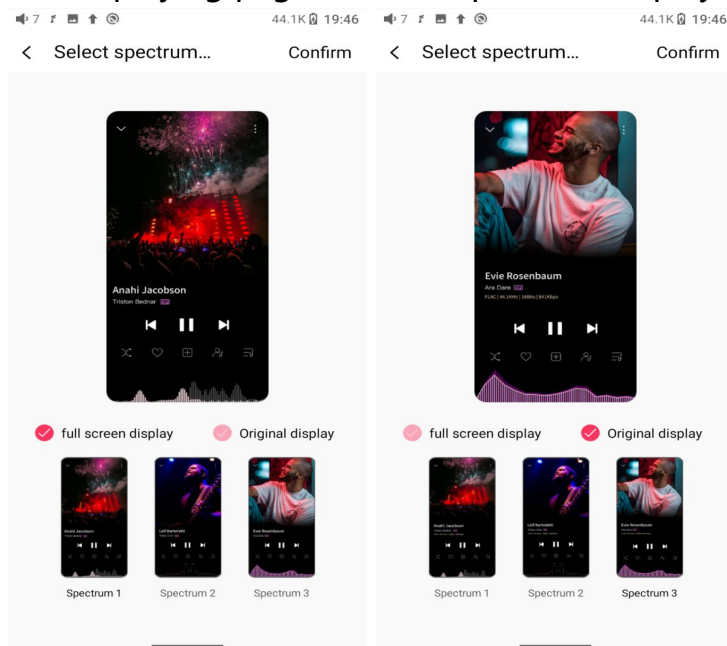

Square cover and large cover:

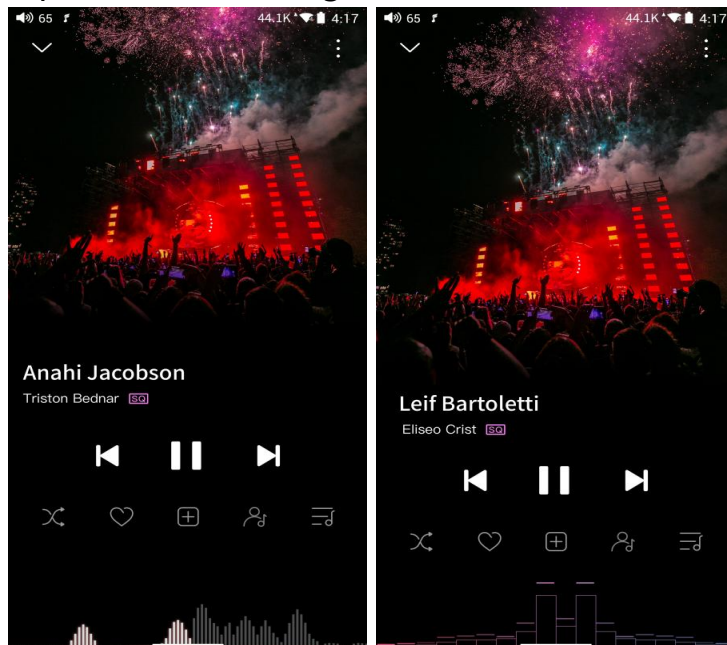

FiiO Music app keeps upgrading and maintaining.

Instructions for commonly-used functions

1. Screenshot

Use 3 fingers to swipe down the screen. Or hold the power button and volume- button together to get a screenshot.

Where does the screenshot store: FiiO JM21\Files\Internal storage\Pictures\Screenshots

2. USB Audio digital output



The JM21 supports USB audio. The setting steps are as follows.

1. Enable ""USB output"" in FiiO Music app of the JM21.
2. Use an OTG cable to connect the JM21 and the external decoder.
3. Open FiiO Music app or other music applications to use the JM21 as a USB digital output device.

It supports most of the decoding devices on the market. For those unsupported, you can turn off the USB output in FiiO Music app, or unplug and re-plug the USB device after quitting the FiiO Music app. If it does not work, please contact us by sending an email to support@fii.com for further help.

3. FiiO Link Bluetooth control

There are mainly 3 steps.

- 1) On the FiiO Music app of the JM21, Settings->FiiO Link->  (on the upper right corner of the display), choose Bluetooth as the Server.
- 2) Connect the JM21 to the mobile phone through Bluetooth.
- 3) On the FiiO Music app of the mobile phone, Settings->FiiO Link->  (on the upper right corner of the display), choose Bluetooth as the Client.

Notes: iPhones only support FiiO Link WiFi control but not Bluetooth.

4. FiiO Link Wifi control

There are mainly 3 steps.

1. Make sure the JM21 and your mobile phone are connected to the same WiFi network.

2. On the FiiO Music app of the JM21, Settings->FiiO Link->  (on the upper right corner of the display), choosing WiFi as the Server. Now an IP address will show up.

3. On the FiiO Music app of the mobile phone, Settings->FiiO Link->  (on the upper right corner of the display), choosing WiFi as the Client. Input the IP address in the pop-up dialog and complete the connection.

Notes: iPhones only support FiiO Link WiFi control but not Bluetooth.

5. How to use the DLNA function?

The DLNA function means the JM21 can read and receive music files stored on the device (name it Device A) which supports DLNA function through WiFi.

1. Make sure the JM21 and Device A are connected to the same WiFi network.

2. On the FiiO Music app of the JM21, tap DLNA on the main menu and

search for Device A to play music of it.

Notes: If there are any devices that cannot use the DLNA function, please give us feedback for further analysis. FiiO Music app does not support music transmission at present but only music reception. We will consider adding the transmission function later.

6.How to use the coaxial function of JM21?

1. Player Settings - Audio - 3.5mm output selection, set to SPDIF.
2. Connect one section of coaxial cable to the 3.5mm audio port of JM21, and connect the other end to the coaxial decoding device.
3. Play music on JM21 player software to output coaxial signal.

Note: At this time, the coaxial signal is decoded in the third-party decoding equipment, JM21 to realize the turntable function.

7. What can be done if I forget my password? How to enter recovery mode?

The device could to be reset to factory data mode in recovery mode if JM21 password is forgotten or JM21 freezes or JM21 no reaction during update.

Turn off the device first. Hold the volume down button and plug a USB cable in for power supply. It will enter recovery mode after turning on. On the display, choose "Wipe data/factory reset->Yes until it finishes. Then choose "Reboot system now" to start the device.

Notes:

Switch menu: short press the volume +/- buttons or previous/next track button

Confirm: short press the power button

Firmware upgrade, factory data reset and technical support

1.How to upgrade firmware?

The JM21 supports online upgrade and local upgrade.

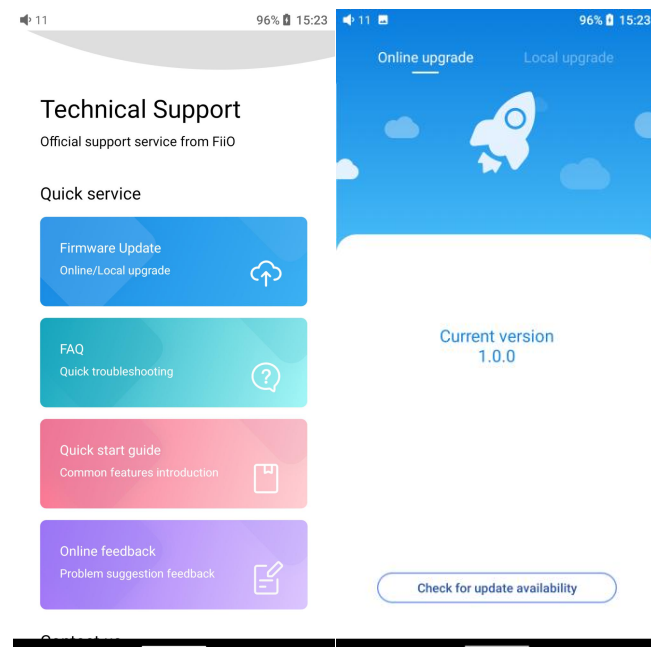

Online upgrade

If a new firmware is available and can be detected (with the JM21 connected to an available internet), an upgrade notification will show up in the notification center. Tap on it to enter the update menu for the online upgrade. If there's no upgrade notification showing up, you can go to the "Technical Support->Firmware Upgrade" menu, and tap the

"Check for updates" icon to check manually.

Local upgrade

Also, the JM21 can be upgraded locally by a firmware package. Download the firmware package file from FiiO website, and copy it to the internal storage of the JM21 or an SD card. Go to the "Technical Support->Firmware Upgrade->Local Upgrade" menu, and find the firmware package file to start the upgrade.

Notes:

1. Do not unzip the firmware package file.
2. Before the upgrade, ensure the power of the device is adequate (>30%) so to avoid upgrade failure.
3. If the device goes to factory mode which cannot detect the firmware, the reason may be that the firmware file is damaged. At this time, press the power button to reboot the device. Re-download the firmware file and restart the upgrade.

2. Force to reboot

Please hold the power button for around 10 seconds until the "FiiO" logo shows up.

3.Factory data reset

If there are some problems happened to the device, perform the factory data reset would help (In the menu of Settings->System->Reset options).

Notes: The "Factory data reset" will erase all data from the internal storage and reset the device to defaults. Please backup corresponding files in advance.

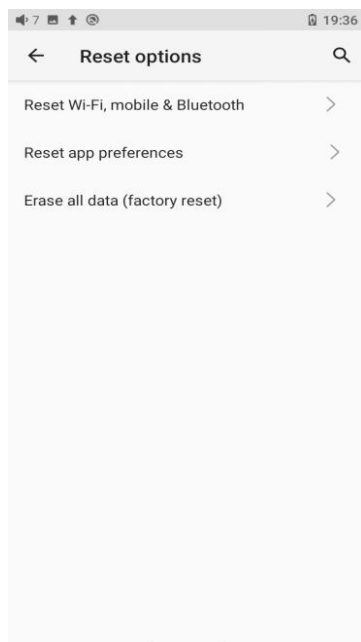

4.Technical support

1) On the homepage, tap Technical Support to enter the menu. Here are several commonly-used functions and our contacts.

2) Firmware update: online and local upgrade are available.

FAQ (frequently asked questions): parts of frequently asked questions and corresponding measures are listed.

3) Quick start guide: tap to check out the internal quick start guide of the JM21.

4) Contact us: here shows our email address, Facebook, Twitter, etc.

